

D-Code Handrinse basin # 07053600002 / 07053600082 / 07053600092

| < 360 mm > |

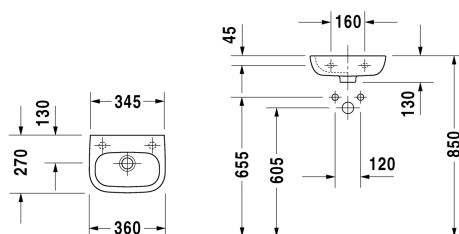

| Handrinse basin | Dimension | Weight | Order number |
|---|--------------|----------------|--------------|
| with overflow, with tap platform, underneath glazed, 360 mm | | | |
| Colors | | | |
| 00 White Alpin | | | |
| Variant | | | |
| ☒ without tap hole | 360 x 270 mm | 5.500 kilogram | 07053600002 |
| ● tap hole on right side | 360 x 270 mm | 5.500 kilogram | 07053600082 |
| ● tap hole on left side | 360 x 270 mm | 5.500 kilogram | 07053600092 |
| Infobox | | | |
| Mandatory in combination with a bottle trap | | | |
| Recommended faucets | | | |
| Single lever basin mixer S ceramic cartridge, Projection 101 mm, flexible connection hoses 3/8", aerator adjustable, normal spray, chrome, maximum temperature can be adjusted on installation, recommended operating pressure 3 - 5 bar, without pop-up waste set, | | | B11010002 |
| Single lever basin mixer S ceramic cartridge, Projection 101 mm, flexible connection hoses 3/8", aerator adjustable, normal spray, chrome, maximum temperature can be adjusted on installation, recommended operating pressure 3 - 5 bar, with pop-up waste set, | | | B11010001 |

All drawings contain the necessary measurements which are subject to standard tolerances. They are stated in mm and are non-binding. Exact measurements, in particular for customised installation scenarios, can only be taken from the finished piece.